

Bridges 2020

12 March 2020
Ricoh, Coventry

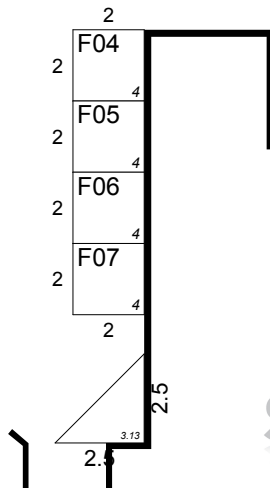
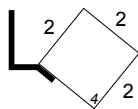
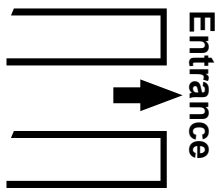
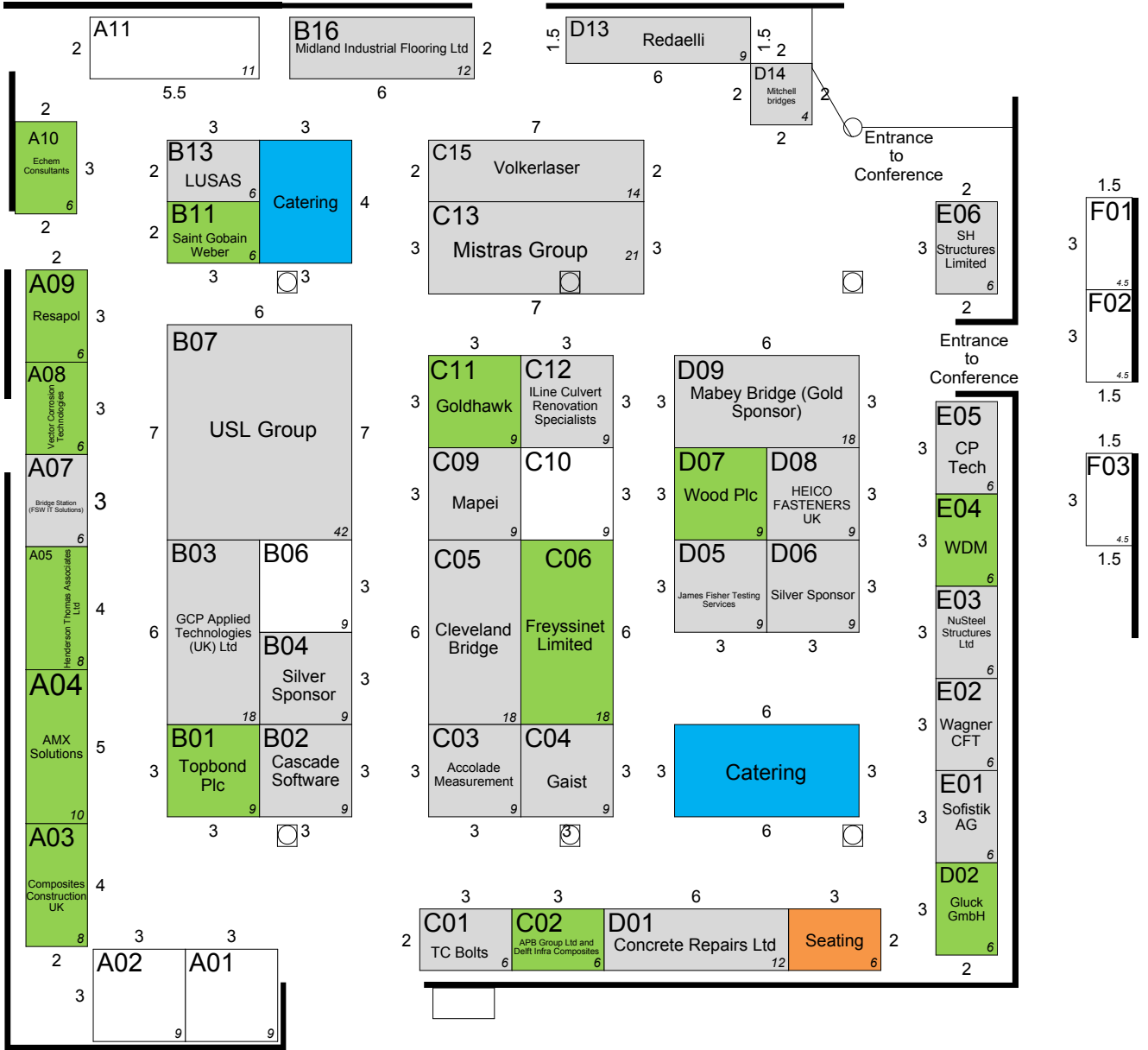

- KEY:
- Catering (30m²) (Qty: 2)
 - Seating (6m²) (Qty: 1)
 - Sold (113m²) (Qty: 14)
 - Table Top (0m²) (Qty: 0)
 - Unsold (85.63m²) (Qty: 15)

showlite
©All rights reserved

Date: 23 Sep 2019
Issue: 126

The dimensions on this plan have not been verified by Showlite Ltd and no responsibility can be accepted for any discrepancies